



DZC 1701/1702

DZC 1701 and 1702 are horizontal anchor windlasses with single or double gypsies. Electric or hydraulic versions are available providing a max. pull of 2200 kgs. It has a gypsy for chains 14, 16 or 18 mm DIN766, 12.5, 14 or 16 mm stud-link.

	DZC 1701E / 1702E	DZC 1701H / 1702H
Drive	AC Electric Motor (210-400V, 3 ph)	Hydraulic Motor
Max. cont. Pull	1750 kg (7500W - 30 min)	1750 kg (30 min)
Max. pull	2200 kg (7500W - 2 min)	1950 kg (2 min)
Haulage speed	13 m/min.	12 m/min.
Gypsy for chain	14-16-18 mm DIN766, 12.5-14-16 Stud-link	14-16-18 mm DIN766, 12.5-14-16 Stud-link
Approximate weight	275 / 325 kg	185 / 220 kg
Current draw (at max. cont.pull)/Hyd. pressure - Oil flow (on motor)	11.2A (5500W) - 15.4A (7500W)	120 bar - 40 lt/min
Motor power	5500W - 7500W (400V - 50hz)	



datahidrolik.com

DZC 1701 H / BS - 14 K /**No. Of Gypsy & Drum**

1701	1 gypsy 1 drum
1702	2 gypsies 2 drums

Drive

E	E. Motor driven
H	Hydraulic driven

Gypsy & Drum Position

L	As the drawing In opposite side
---	------------------------------------

Material

B	Bronze
Kr	Stainless steel
P	Steel

Control Type

M	Local control
S	Solenoid control
E.	Motor drive

Chain Type / Size

14 K	14 mm. DIN 766
16 K	16 mm. DIN 766
18 K	18 mm. DIN 766
12 L	12.5 mm. Stud-link
14 L	14 mm. Stud-link
16 L	16 mm. Stud-link

E. Motor

5	5.5 kW 380 V AC E. Motor
7	7.5 kW 380 V AC E. Motor

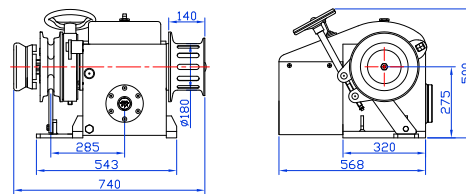

DZC 1701H

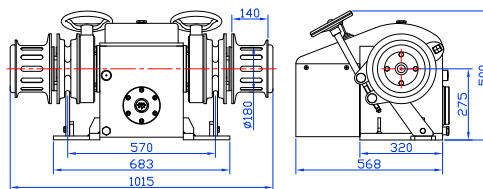

DZC 1702H

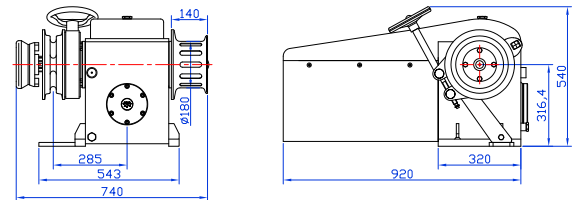

DZC 1701E

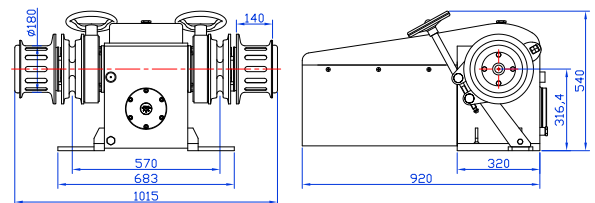

DZC 1702E

FEATURES

Gypsies are equipped with both clutch and band brake to allow independent operation of gypsy and warping drum.

Chain can be dropped by loosing band brake.

Gypsy is engaged by means of dog clutch.

Electric motor driven models are equipped with torque limiting coupling for over load protection.

Body is galvanized steel work. Top cover and motor cover are marine grade aluminium. All covered with polyurethane paint.

High strength drive shaft and brake screw are stainless steel.

DOL starter for electric motor driven models.

OPTIONS

AC electric motor drive.

Hydraulic motor drive.

Polyurethane painted steel gypsy, clutch and warping drum.

Bronze gypsy, clutch and warping drum.

Mirror polished stainless steel gypsy, clutch and warping drum.

Single or double gypsy.

For single gypsy models, right and left versions available.

Starter with frequency converter.

Hydraulic control valve installed on windlass.