

## DZC 3501/3502

DZC 3501 and 3502 are horizontal anchor windlasses with single or double gypsies. Electric or hydraulic versions are available providing a max. pull of 4100 kgs. It has a gypsy for chains 18, 20 or 23 mm DIN766, 17.5, 19, 20.5, 22 or 24 mm stud-link.

	DZC 3501E / 3502E	DZC 3501H / 3502H
Drive	AC Electric Motor (210-400V, 3 ph)	Hydraulic Motor
Max. cont. Pull	3000 kg (30 min)	3700 kg (30 min)
Max. pull	3700 kg (2 min)	4100 kg (2 min)
Haulage speed	14 m/min.	12 m/min.
Gypsy for chain	18-20-23 mm DIN766, 17.5-19-20.5.-22-24 Stud-link	18-20-23 mm DIN766, 17.5-19-20.5.-22-24 Stud-link
Approximate weight	610 / 820 kg	460 / 615 kg
Current draw (at max. cont.pull)/Hyd. pressure - Oil flow (on motor)	21A (11000W)	140 bar - 55 lt/min
Motor power	11000W (400V - 50hz)	



[datahidrolik.com](http://datahidrolik.com)

**DZC 3501 H / PM - 17.5L****No. Of Gypsy & Drum**

3501	1 gypsy 1 warping drum
3502	2 gypsies 2 warping drums

**Drive**

E	E. Motor driven
H	Hydraulic motor driven

**Gypsy & Drum Position**

L	As the drawing In the opposite side
---	--

**Material**

B	Bronze
Kr	Stainless steel
P	Steel

**Control Type**

M	Local control
S	Solenoid control
	E. Motor drive

**Chain Type / Size**

18K	18 mm DIN766
20K	20 mm DIN766
23K	23 mm DIN766
17.5L	17.5 mm Stud-link
19L	19 mm Stud-link
20.5L	20.5 mm Stud-link
22L	22 mm Stud-link
24L	24 mm Stud-link

**E. Motor**

11	11 kW 380 VAC E. Motor
----	------------------------

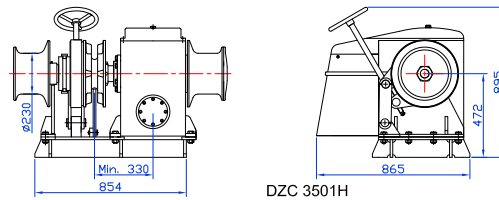

DZC 3501H

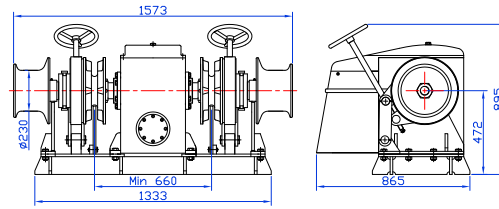

DZC 3502H

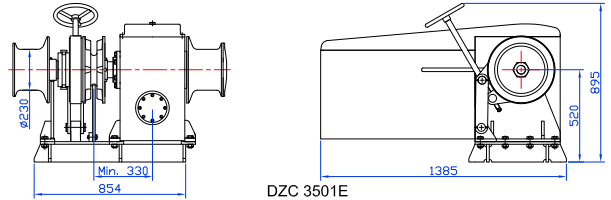

DZC 3501E

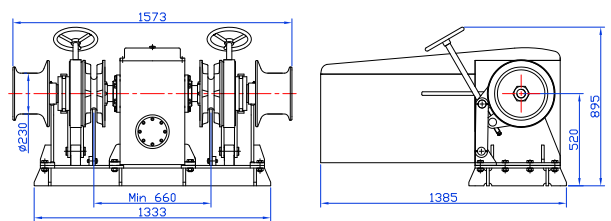

DZC 3502E

## FEATURES

Gypsies are equipped with both clutch and band brake to allow independent operation of gypsy and warping drum.

Chain can be dropped by losing band brake.

Gypsy is engaged by means of dog clutch.

Electric motor driven models are equipped with torque limiting coupling for over load protection.

Body is galvanized steel work. Top cover and motor cover are marine grade aluminium. All covered with polyurethane paint..

High strength drive shaft and brake screw are stainless steel.

DOL starter for electric motor driven models.

Increased strength with vertical supports at the ends of main shaft which also allows to arrange the distance between two gypsies.

## OPTIONS

AC electric motor drive.

Hydraulic motor drive.

Polyurethane painted steel gypsy, clutch and warping drum.

Bronze gypsy, clutch and warping drum.

Mirror polished stainless steel gypsy, clutch and warping drum.

Single or double gypsy.

For single gypsy models, right and left versions available.

Starter with frequency converter.

Hydraulic control valve installed on windlass.

Foundation to be welded on deck.